



## TransplantREADY<sup>®</sup> DSAEK

Preloaded in a  
Weiss Glass Cannula\*

*"Beautiful Case. Opened up right away."*

*—Priya M. Mathews M.D., M.P.H.*

**100+ Ophthalmologists Report:**  
Delivery using fluid injection  
provides deep stable chamber while  
promoting opening of the graft.

3x less endothelial cell loss<sup>†</sup> compared  
to pull-through and insertion techniques.

**Full-Range of Specifications<sup>‡</sup>**

- 40-100+ microns
- 7.0-8.75mm diameters



LIONS  
**WORLD VISION**  
INSTITUTE™

So the world can see.

# TransplantREADY® DSAEK Preloaded in a Weiss Glass Cannula\*

Designed specifically for ultrathin DSAEK grafts, 40-70 microns.

## Preassembled system includes:

- End-cap luer lock connection
- 14 French tubing
- Weiss Glass Cannula
- Protective silicone cap

## Closed System

- Promotes opening of graft with fluid
- Provides deep stable chamber without AC maintainer

## TransplantREADY®

The objective of the TransplantREADY DSAEK in a Weiss Glass Cannula is to ease transplant procedures using prepared, preloaded grafts while preserving endothelial cell count.

- Prepared and preloaded for no-touch delivery
- Less traumatic to endothelium<sup>†</sup>
- Small 2.8 mm outer diameter
- Eliminates need for donor punch and micro forceps

## Specifications

The Weiss Glass Cannula is custom designed for ultrathin DSAEK, 40-70 microns with a diameter between 7.0-8.0mm. In addition we are able to accommodate a full-range of graft specifications (up to 100+ microns and 8.75mm diameter as requested).

## Preparation

Each TransplantREADY DSAEK graft is prepared using the high pressure anterior chamber (HPAC) method. HPAC provides documented benefits including graft yield, accuracy, and repeatable control (pre-cut)—while maintaining viable endothelium. The graft is prepunched to desired diameter, premarked, and preloaded into the Weiss Glass Cannula.

## Storage & Transport

- OCT images show the preloaded graft positioned in DSAEK Weiss Glass Cannula is rounded and maintains its shape without collapsing
- Preloaded grafts are stored vertically in a vial of FDA approved cornea preservative
- Graft orientation is visible inside the Weiss Glass Cannula and maintains position during transport

## Tips, Videos & Information

For the latest information, including surgical videos, surgeon feedback, and best practices, visit: [LWVI.org](http://LWVI.org).

**Request TransplantREADY DSAEK preloaded in a Weiss Glass Cannula.**

\*The Weiss Glass Cannula is a Class 1 Medical Device, Product Code HMX, manufactured by Gunther Weiss Scientific Glassblowing, Inc., an FDA Registered Medical Device Manufacturer - Establishment Registration #3005489413

†2022 ASCRS presentation DSAEK Graft Endothelial Cell Damage with Pull-Through Busin Glide, Insertion Forceps, and Preloaded Injectable Technique.

‡Designed for ultrathin DSAEK, 40-70 microns with a diameter between 7.0-8.0mm, but able to accommodate a full-range of graft specifications (up to 100+ microns and 8.75mm diameter as requested).



Inside DSAEK Weiss Glass Cannula, graft maintains position.

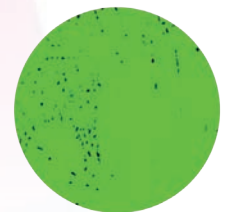

**2.8% Cell Loss**  
Preloaded in DSAEK Weiss Glass Cannula and stored for 24 hours

## TIPS FROM THE EXPERTS:

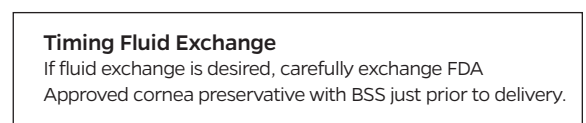
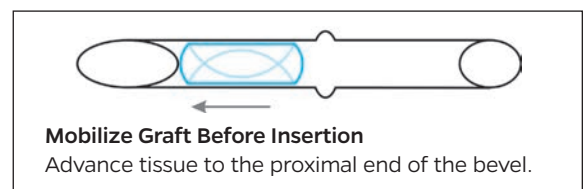
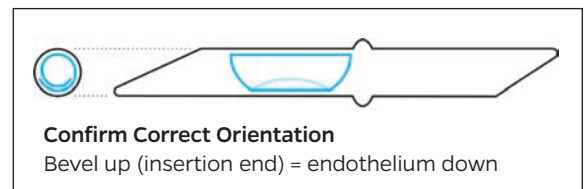

So the world can see.

1410 N 21st Street, Tampa, FL 33605-5313 | 813.289.1200 | [LWVI.org](http://LWVI.org)

Formerly Lions Eye Institute for Transplant & Research

v.04.12.2023